

Cable Accessory

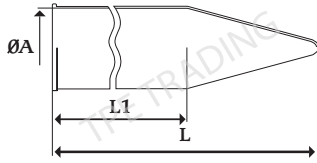

Shroud

It is made of PVC materials, It is used to protect the BDM series cable glands

Size	15	20	25	32	40	50	63	75	90	115
A	27	33	38	48.5	58.5	71.5	90	98	98	140
L	110	117	118	150	150	170	200	215	220	278
L1	58	62	80	90	90	100	130	185	200	210

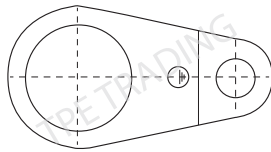

Earth Tag

It is used for provide the earthing connection between cable in glands and equipments.

Mode	M20	M25	M32	M40	M50	M63	M75
	G1/2"	G3/4"	G1"	G1 1/4"	G1 1/2"	G2"	G2 1/2"
Rate Short Circuit Current	3.06	4.00	5.40	7.20	10.40	10.40	10.40



Lock Nut

It is used to fix the Glands to the equipment. It is with brass, nickel plated, carbon steel, and stainless steel materials. We can provide lock nut with thread G1/2" - G4, M16 - M75, thread can be customized.



PTFE Washer

It is used for sealing glands, and equipment, for water-proof and dust-proof, polytef materials. Size : G1/2" - G4, M16 - M75



Red Fibre Washer

It is used for sealing glands, and equipment, for water-proof and dust-proof, GKF materials. Size : G1/2" - G4", M16 - M75



Serrated Washer

Stainless Steel materials, It prevent the loosening between the lock nut, and equipment when the equipment is running. Size : G1/2" - G4", M16 - M75